

From: [Aaron Pauliuk](#)
To: [Darryl Walker](#); [David Chesney](#); [Helen Fathers](#); [Erika Johanson](#); [Scott Kristjanson](#); [Anthony Manning](#); [Christopher Trevelyan](#)
Cc: [Carl Isaak](#); [Tracey Arthur](#); [Debbie Johnstone](#)
Subject: BYLAW 2351: Petition for Beachway - Below Market Rental + Market Condos in White Rock one block from Peace Arch Hospital
Date: February 23, 2021 9:25:05 PM
Attachments: [Beachway Handout.pdf](#)
[Beachway Petition.pdf](#)
[Completed Petitions.pdf](#)

CAUTION: This email originated from outside of the organization. Do not click links or open attachments unless you recognize the sender and know the content is safe.

Dear Mayor and Council

Please see below the email and attachments that were sent out starting February 1st inquiring into the support of the Beachway project. White Rock residents stepped up and helped out to gather support as they believe this is a greatly needed project for our city.

As of tonight I have **267** White Rock residents and or land owners in support of the project.

Please see attached Names, addresses and phone numbers on attached "Completed Petitions".

Tracey please add this as a submission to the Public Hearing for March 1st.

Thanks,

Aaron Pauliuk

Subject: Petition for Beachway - Below Market Rental + Market Condos in White Rock one block from Peace Arch Hospital

Hi

I am sending this email to see if you would support this project, in January it received 1st and 2nd reading by White Rock Council, the Public Hearing is scheduled for March 1st.

Due to COVID it is going to be a virtual meeting and probably not a lot of people will attend.

In 2017 we did a door to door petition for signatures in support of higher density in the area by White Rock residents and received **204**.

Beachway is located one block from Peace arch Hospital from Maple to Lee St on North Bluff and 1570 & 1580 Maple St.

This area of North Bluff is an arterial route to the highway 99 interchange and on a major bus route. It also allows the city to achieve higher density without blocking the cherished views of the mature neighborhoods to the South.

Consisting of:

- One six story below market rental building owned and operated by a non-profit on North Bluff containing 25 units.
- One six story market condo building on North Bluff containing 49 units.
- Fourteen three story Town Houses on Maple St.

If you are a White Rock resident or White Rock land owner and support this development please fill it out and email it back, everyone in your house hold can be listed if they are in favor.

If you don't have a scanner you can take a picture and text it to me

I would like to ask that if you have any family or friends in W.R. you forward this email to them.

Aaron Pauliuk
15674 North Bluff Road
White Rock, B.C.



Virus-free. www.avg.com

Beachway will bring affordable homes to the community with ownership and rental options

The project will transform six existing single family home lots into a vibrant new community with a mix of residential units for “growing up and growing old” in the same neighbourhood. Open and engaging public realm spaces are provided to enhance the character of the built environment, supporting the City of White Rock’s socially-oriented urban design principles.

The proposed use, height, and density are consistent with the East Side Large Lot Infill Area designation in the City of White Rock Official Community Plan (OCP).

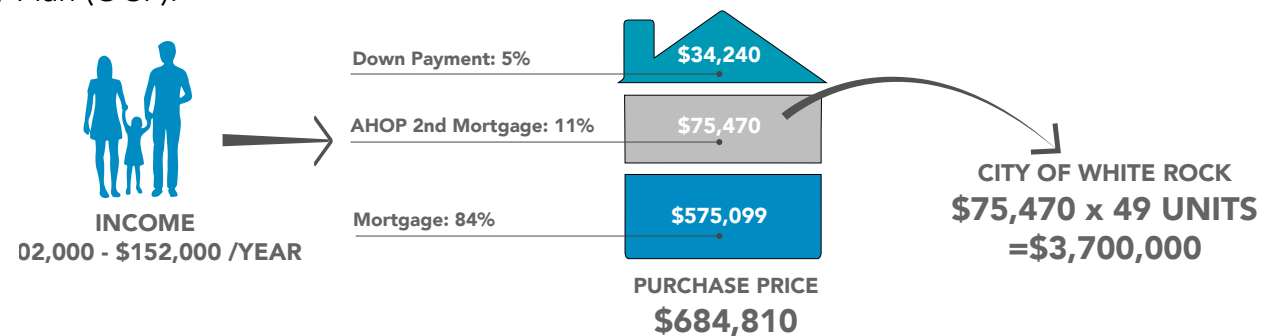

Affordable home ownership options includes 49 1 - 3 bedroom apartments. There are also 25 affordable rental units.

The Affordable Home Ownershop Plan (AHOP), the Provider (Developer) provides funding for the 2nd mortgage, representing 11% of the total cost. When the unit is resold by the purchaser, this amount is transferred to the City. At an average purchase price of \$684,810, this will result in total future revenue of \$3,700,000 for the City of White Rock.

Unit Mix =
84% affordable units & 16% market

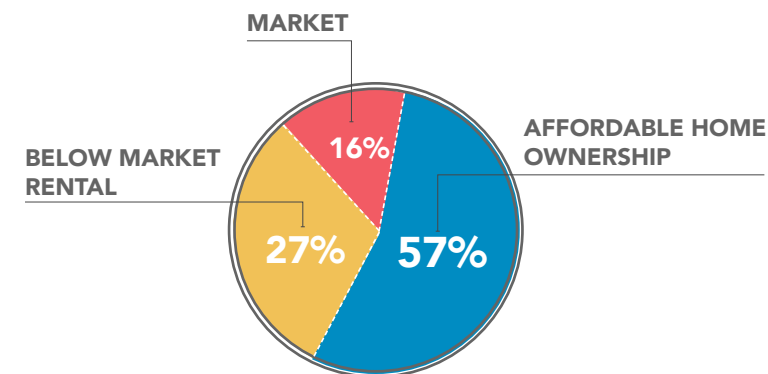

Quick Summary

Height: 2 - six storey buildings
14 - three storey townhouses

6 Storey Total Homes: 74 (100%)
3-br: 6 (8%)
2-br: 45 (61%)
1-br: 23 (31%)
Rental: 25 (33.7%)
Density: 2.49

Townhouses Total Homes: 14
Density: 1.41

Total Parking: 140 + 1 Loading

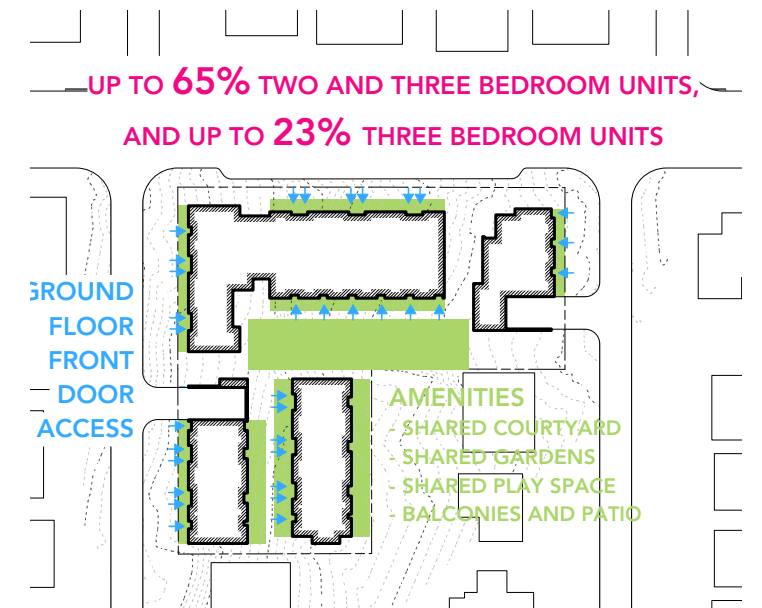

Community Benefits

Community benefits include the following:

BEYOND ART: Striking architecture frames the gateway to White Rock along North Bluff Road.

ENERGY PERFORMANCE: The buildings’ energy performance is 30% better than 2016 building codes, which will result in lower utility bills for residents.

WELLNESS BY DESIGN: Indoor and outdoor social spaces nurture community connections; 2- and 3-bedroom homes (over 55% of total) invite families to make their home here.

ENVIRONMENTAL STEWARDSHIP: Construction will be made green through off-site assembly and innovative prefabricated timber materials, resulting in zero waste to landfill.

OFFICIAL COMMUNITY PLAN ALIGNMENT: The White Rock OCP—Imagine White Rock 2045—from 2017 encourages more housing in the East Side Large Lot Infill area.

HOUSING CLOSE TO TRANSIT AND JOBS: North Bluff Road is a major transit route, and the site is only a five minute walk to major employment centres, such as the Peace Arch Hospital. It’s also only a ten minute walk to shops and services at Semiahmoo Centre.



BEACHWAY

Petition

Mayor and Council

Beachway is located one block from Peace arch Hospital from Maple to Lee St on North Bluff and 1570 & 1580 Maple St.

This area of North Bluff is an arterial route to the highway 99 interchange and on a major bus route. It also allows the city to achieve higher density without blocking the cherished views of the mature neighborhoods to the South.

Consisting of:

- One six story below market rental building owned and operated by a non-profit on North Bluff containing 25 units.
- One six story market condo building on North Bluff containing 49 units.
- Fourteen three story Town Houses on Maple St.

As a member of the White Rock Community I would like you to know that I am in full support of this project.

	Name	Address	Phone
①	Andrew Green	14778 Thrift Ave White Rock.	604-866-7062
②	Arielle Green	14778 Thrift Ave White Rock	604-809-2316
③	Nord Crawford	15674 North Bluff RD White Rock	604-613-1929
④	W. Christiansen	1593 Lee St White Rock	778-991-5052
⑤	P. Christiansen	1593 Lee St White Rock	778-991-5072
⑥	Tamal SABRAH	1570 Maple St	604-700-3848
⑦	Georgette HOURANI	1570 Maple St.	604-200-3848
⑧	Tyler Blackmore	15654 North Bluff RD.	778-681-8033
⑨	Brad Ovestordick	15654 North Bluff RD	604-612-0775
⑩	Lynn Sinclair	15490 Columbia Ave W.R.	604-340-2276
⑪	Aaron Pauliuk	15654 North Bluff RD W.R.	604-813-5335
⑫	Jennifer Boyd	15655 Russell Ave W.R.	604-354-3449
⑬	Bill Mikail	1553 Lee St	604-541-9549
⑭	LAM PADAM	15721 Russell Ave	778-861-0049
⑮	SHAMMA MAMAT	15721 Russell Ave	778-245-4708
⑯	Christine Hong	15750 Russell Ave	778-319-1761
⑰	Karl Pennerogst	15730 Russell Ave	604-366-1857
⑱	Lesley Gifford	15720 Russell Ave	778-772-2597

BEACHWAY

Petition

Mayor and Council

Beachway is located one block from Peace arch Hospital from Maple to Lee St on North Bluff and 1570 & 1580 Maple St.

This area of North Bluff is an arterial route to the highway 99 interchange and on a major bus route. It also allows the city to achieve higher density without blocking the cherished views of the mature neighborhoods to the South.

Consisting of:

- One six story below market rental building owned and operated by a non-profit on North Bluff containing 25 units.
- One six story market condo building on North Bluff containing 49 units.
- Fourteen three story Town Houses on Maple St.

As a member of the White Rock Community I would like you to know that I am in full support of this project.

	Name	Address	Phone
19	Denise Cohen	13902 Malabar Ave White Rock BC	604-802-2749
20	Roy Jackson	14862 Roper Ave	604-531-8707
21	Les Roper	15161 Roper Ave	" 308-1198
22	David Cohen	13902 Malabar Ave W.B. BC	604-202-2749
23	J. LEES	15676 RUSSELL AVE W/R	604-531-2908
24	J. LEES	" " "	" " "
25	T. Johnstone	983 Kent Street White Rock	604-802-8049
26	C. JOHNSTONE	" " "	604-303-6723
27	VICTORIA BACH	17620 RUSSELL AVE " "	604-525-9120
28	Lynne Gahage	15738 McBeth Rd Surrey	604-868-7579
29	RANJIT D	15288 Royal AVE	604-626-8424
30	BALJIT D	15288 Royal "	604-626-8424
31	Ryan McKenzie	14476 North Bluff RD.	604-536-0510
32	James Rockwell	1434 Oxford St WR	778-231-5021
33	Ludie Klinek	1434 Oxford St WR	778-231-5021
34	Michelle Lope	1580 Maple St WR	604-418-4547
35	Georgeloch	1580 Maple St WR	604-531-2890
X	Cole Brown	2729 158th	604-209-3369

BEACHWAY

Petition

Mayor and Council

Beachway is located one block from Peace arch Hospital from Maple to Lee St on North Bluff and 1570 & 1580 Maple St.

This area of North Bluff is an arterial route to the highway 99 interchange and on a major bus route. It also allows the city to achieve higher density without blocking the cherished views of the mature neighborhoods to the South.

Consisting of:

- One six story below market rental building owned and operated by a non-profit on North Bluff containing 25 units.
- One six story market condo building on North Bluff containing 49 units.
- Fourteen three story Town Houses on Maple St.

As a member of the White Rock Community I would like you to know that I am in full support of this project.

Name	Address	Phone
36 Tolson	15235 Pacific Ave	604 781 5920
37 D. Smith	15158 Royal Ave	604 729 2019
38 B. Dressler	15826 Russell Ave	604 445 9168
39 M. H. H. H.	15157 - Pleasant	
40 J. Gale	1368 Foster St	
41 J. Danish	Roper Ave. 1489 Cedar.	
42 D. D. D.	15284 Buena Vista	
43 E. W. W.	(15066) Victoria Ave. (PRIVATE)	236-800-4421
44 J. J. J.	7064 118th St. Ritz BC	778-241-4423
45 Rick ARMSTRONG	1559 COLINA BA	778-837-2259
46 MARIN BOZIC	15862 MCBETH RD SURREY	778 829 5589
X Mallory Manley	5837 Sappins Way	778-846-1625
47 J. J. J.	15517 Main Dr.	604-533-9320
48 J. J. J.	15210 PACIFIC AVE.	604-542-2670
49 B. B. B.	1031 Finlay St	
50 S. S. S.	1022 E. W. W. St	
51 J. J. J.	4/9 Maple	778 887 2121
X J. J. J.		

22

BEACHWAY

Petition

Mayor and Council

Beachway is located one block from Peace arch Hospital from Maple to Lee St on North Bluff and 1570 & 1580 Maple St.

This area of North Bluff is an arterial route to the highway 99 interchange and on a major bus route. It also allows the city to achieve higher density without blocking the cherished views of the mature neighborhoods to the South.

Consisting of:

- One six story below market rental building owned and operated by a non-profit on North Bluff containing 25 units.
- One six story market condo building on North Bluff containing 49 units.
- Fourteen three story Town Houses on Maple St.

As a member of the White Rock Community I would like you to know that I am in full support of this project.

	Name	Address	Phone
X	SKIN DEAN	15355 16TH AVENUE, Surrey, BC	778-302-6379
X	Collin Van Den	6360 Ross Street, Vancouver, BC	778 988 8629
52	Sturmy	1572 North Bluff road	778 575 862
53	any	1572 North Bluff ave White Rock	607-817-8087
X	Brian Cheng	3532 150 Street Surrey BC	778 863 8548
54	Anna Reznik	205 1380 Gorge St White Rock	778 898 5043
55	Nigel Chivers	402-15025 Victoria Ave W.R.	778 228 0380
56	Lindsay Mawh	150 Martin St W.R.	604.674.2172
57	Aiden Duffy	2890 57st	604.987.1391
58	Natalie Dobbs	White rock	604.600.5943
59	Allen Roden	15 White Rock	778-534-9600
60	Robin Mcla	White Rock	250-575-0000
61	Dea Gato	1370 OVERALL ST WR.	778 549-2405
62	Pat Mook	1066 Centre St.	604 866 3589
63	Jeff	302-1225, KERRLIN	604 887 5274
X	Dore Milwa	223 16989 Road	604 538-2415
64	Alex Gwir	White Rock	604.441.441

BEACHWAY

Petition

Mayor and Council

Beachway is located one block from Peace arch Hospital from Maple to Lee St on North Bluff and 1570 & 1580 Maple St.

This area of North Bluff is an arterial route to the highway 99 interchange and on a major bus route. It also allows the city to achieve higher density without blocking the cherished views of the mature neighborhoods to the South.

Consisting of:

- One six story below market rental building owned and operated by a non-profit on North Bluff containing 25 units.
- One six story market condo building on North Bluff containing 49 units.
- Fourteen three story Town Houses on Maple St.

As a member of the White Rock Community I would like you to know that I am in full support of this project.

	Name	Address	Phone
66	Austin Jorgensen	14832 Buena Vista Ave, White Rock	604-765-5221
67	Lois LePake	15152 Russell Ave	778-411421
68	TREVELLINGER	15170 PROSPECT	778-549-0803
69	KEVIN ELLINGSEN	15170 PROSPECT	778-840-1079
70	Mary-Lou	White Rock	778-847528
71	DAVE HOMER	WHITE ROCK	778-838-8101
72	M. ROTH F	White Rock	778-549-9931
73	J. DOWNEY	11478 Johnston	416-508-2548
X	Tanya McKay	14582 86 ave	778-316-4946
X	R. Jambour	16280 11 ave	604-538-3761
74	CHRIS SMITH	15251 ROYAL AVE	778-968-7930
75	ANDY KEINE	1225 NEELIN	604-542-5099
76	G. STAIN	W. 9.11	
77	ANDY CUFAR	WHITE ROCK	604-9104056
78	TRAVIS	White Rock	604-616-1900
79	Lynne Bost	White Rock	604-262-6587
80	Maxwell Ravish	1243 67st Street	604-794-7303
81	LEE K. & C	1280 FIR ST	604-818-8395

BEACHWAY

Petition

Mayor and Council

Beachway is located one block from Peace arch Hospital from Maple to Lee St on North Bluff and 1570 & 1580 Maple St.

This area of North Bluff is an arterial route to the highway 99 interchange and on a major bus route. It also allows the city to achieve higher density without blocking the cherished views of the mature neighborhoods to the South.

Consisting of:

- One six story below market rental building owned and operated by a non-profit on North Bluff containing 25 units.
- One six story market condo building on North Bluff containing 49 units.
- Fourteen three story Town Houses on Maple St.

As a member of the White Rock Community I would like you to know that I am in full support of this project.

	Name	Address	Phone
82	Christina Row	302-15158 Royal Ave.	778-988-7836
83	Geoff Ashew	1589 Martin St	778-847-8725
84	Cassie Dekker	1589 Martin St.	
X	Austin Kao	15288 76 Ave Surrey	604-710-2580
85	Michael Fiedler	1558 West Street, White Rock, BC	778-229-5125
X	Marie Annaby	1279 90 St Surrey	978-239-0277
86	Sharon Symes	White Rock	604-90-2227
87	Kam Atkinson	15289 Martin Ave	604-714-1972
88	John Gwaller	15449 Martin Dr	604-626-5493
89	James Paxon	15573 GOGGS AVE.	604-368-2413
90	Kimberly Kaurailo	15573 Goggs Ave	604-908-1605
91	J. N. Delane	15365 Pacific	604-812-4491
92	Sean Ahern	206 1544 Fir St	604-377-1253
93	Erin MacCoy	1369 Winter St.	604-314-4217
94	PG McConchie	1365 Fir St	604-388-3251
X	Nicki Sidon	233 124th St. Surrey	604-319-0080
95	Jana Nade	14756 Gordon Ave	604-925-2544
96	Kevin McFarlane	1473 104th Ave RD	778-326-5652

BEACHWAY

Petition

Mayor and Council

Beachway is located one block from Peace arch Hospital from Maple to Lee St on North Bluff and 1570 & 1580 Maple St.

This area of North Bluff is an arterial route to the highway 99 interchange and on a major bus route. It also allows the city to achieve higher density without blocking the cherished views of the mature neighborhoods to the South.

Consisting of:

- One six story below market rental building owned and operated by a non-profit on North Bluff containing 25 units.
- One six story market condo building on North Bluff containing 49 units.
- Fourteen three story Town Houses on Maple St.

As a member of the White Rock Community I would like you to know that I am in full support of this project.

	Name	Address	Phone
97	Susan Vollmer	104-1250 MARTIN STREET, WHITE ROCK	604-865-2941
98	Wayne Vollmer	104-1250 MARTIN STREET, WHITE ROCK	778-953-6865
99	Harp Sarah	1539 maple St w.R.	604-765-9557
100	Harp Sarah	1529 maple St w.R.	604-765-9557
101	Harp Sarah	1509 maple St. w.R.	604-765-9557
102	Harp Sarah	15631 Russell Ave w.R.	604-765-9557
103	Matt Weber	15704 North Bluff Rd w.R.	604-889-0705
104	Matt Weber	15724 North Bluff Rd w.R.	604-889-0705
105	Matt Weber	15728 North Bluff Rd w.R.	604-889-0705
106	Matt Weber	15738 North Bluff Rd w.R.	604-889-0705
107	Matt Weber	15748 North Bluff Rd w.R.	604-889-0705
108	Matt Weber	15758 North Bluff Rd w.R.	604-889-0705
109	Matt Weber	15770 North Bluff Rd w.R.	604-889-0705
110	Blue Pongitz	2-1426 Finlay St.	604-338-5279
111	Barbara Fraser Tilley	1-1426 Finlay St	604-538-3457
112	Trenor Tilley	1-1426 Finlay St.	"
113	Elizabeth Tilley	1-1426 Finlay St.	"
114	Klondahotelle	4-1426 Finlay St.	604-531-4454

BEACHWAY

Petition

Mayor and Council

Beachway is located one block from Peace arch Hospital from Maple to Lee St on North Bluff and 1570 & 1580 Maple St.

This area of North Bluff is an arterial route to the highway 99 interchange and on a major bus route. It also allows the city to achieve higher density without blocking the cherished views of the mature neighborhoods to the South.

Consisting of:

- One six story below market rental building owned and operated by a non-profit on North Bluff containing 25 units.
- One six story market condo building on North Bluff containing 49 units.
- Fourteen three story Town Houses on Maple St.

As a member of the White Rock Community I would like you to know that I am in full support of this project.

	Name	Address	Phone
115	David Sexsmith	15154 Roper Ave	604-754-1238
116	Stephen Klever	15880 Columbia Ave W.R.	604 314 0420
117	Paul Perkins	14899 Marine Dr	604-765-3378
118	Esther Brown	7450 Dorchester Dr	778 525 2301
119	Katherine Lyon	31-1415 Camery Hill Rd	778 628 8339
120	Bridget Perry Fox	1520 Vidal St.	236 990 939
X	Markus		
121	H. Shaw	1330 Martin St.	604 868 6400
122	CEPARKES	15309 Royal Ave	236 989 1975
123	S Schappert	15484 Victoria Ave	778 953 2160
124	JERRY MILLER	15066 Royal Ave	778 837 5243
125	Chrystal	15010 Prospect	778 957 6794
X	LIZ TROY	15325 25th Surrey	604 574 4192
126	Michael	M 15321 Russell	778 231 305
127	Krooke Colby	15066 Victoria	604 617 8478
128	Kelly Tournemile	15115 Prospect Ave WR BC	778 855 0878
X	Shawn Wang	-	236 880 5464
129	Victoria Bennett	14022 North 8th Rd WR BC	604 537 3007

Kt

BEACHWAY

Petition

Mayor and Council

Beachway is located one block from Peace arch Hospital from Maple to Lee St on North Bluff and 1570 & 1580 Maple St.

This area of North Bluff is an arterial route to the highway 99 interchange and on a major bus route. It also allows the city to achieve higher density without blocking the cherished views of the mature neighborhoods to the South.

Consisting of:

- One six story below market rental building owned and operated by a non-profit on North Bluff containing 25 units.
- One six story market condo building on North Bluff containing 49 units.
- Fourteen three story Town Houses on Maple St.

As a member of the White Rock Community I would like you to know that I am in full support of this project.

	Name	Address	Phone
130	Jasmin Khosay	15839 Cliff Ave White Rock	(604) 725-4076
131	James MacDonald	15839 Cliff Ave White Rock, Bc	(604) 441-1870
132	Paige Read	1569 Corg Rd w.A. V4B3T1	778-883-0063
133	JAN FRASER	1592 STEVENS ST W.R.	604-535-9040
134	Bari McMillen	15291 Victoria Ave w.R.	604-727-8844
135	Wayne McMillen	15291 Victoria Ave w.R.	604-220-2858
136	Kanwar Dhamrait	1265 Stayte Road w.A.	604-355-6789
137	Gurpreet Dhamrait	1265 Stayte Road w.A.	" "
138	Harsimar "	" " " "	" "
139	Jag Hehar	1243 Stayte Road w.A.	Jag1hehar@gmail.com
140	Barb Howes	1592 Stevens St w.A.	604-535-9840
141	Derek Townsend	1570 Maple ST w.A.	604-687-2200
142	Benjamin Curry	1580 Maple ST w.A.	604-687-5325
143	Morgan Brewster	15664 North Bluff Rd w.A.	778-989-2739
144	Derek Townsend	1593 Lee St w.A.	604-687-2200
145	Alexa Brewster	15655 Russell Ave w.A.	604-786-4894
146	Harp Saron	1559 Maple St w.A.	604-765-9557
147	Harp Saron	1549 Maple St w.A.	604-765-9557

BEACHWAY

Petition

HALL

Mayor and Council

Beachway is located one block from Peace arch Hospital from Maple to Lee St on North Bluff and 1570 & 1580 Maple St.

This area of North Bluff is an arterial route to the highway 99 interchange and on a major bus route. It also allows the city to achieve higher density without blocking the cherished views of the mature neighborhoods to the South.

Consisting of:

- One six story below market rental building owned and operated by a non-profit on North Bluff containing 25 units.
- One six story market condo building on North Bluff containing 49 units.
- Fourteen three story Town Houses on Maple St.

As a member of the White Rock Community I would like you to know that I am in full support of this project.

	Name	Address	Phone
X	Stacy McNamee	12829 - 63B Ave Surrey	604-594-1511
148	Theresa	104-1327 Bett St White Rock	749-9074666
149	R. Zachary	308-1319 MARTIN W.R.	604-3075054
150	J. P. J.	106-15210 Pacific Ave	405-616-6511
151	J. Michael	201-1355 Winter St W.R.	604-536-7513
152	Trudy Bishop	215-1280 Fir St. White Rock	604-538-3543
153	Donna	103-15169 Bering Vista Ave	778-388-8662
154	Traci Antonio	1350 Verall St.	581-777-9927
155	J. Boock	939 Finlay St. White Rock	718-2316779
156	Jonathan Page	14853 Bernista Ave	604-542-1967
157	M. McKeel	103-1280 Fir ST.	604-881-5401
158	Darius	15544 Victor Ave	611-5406
159	T. GARMAN	" "	599-6379
160	S. Ascel	1160 Oxford ST	250-689-8785
161	A. KOTENKA	15432 16A Ave.	604-833-9104
162	E. McGinn	912 Parker St	778-836-4110
163	Bonnie Love	14881 N Bluff Rd	778-951-2121
164	J. M. M. M.	14995 Main Rd	604-236-2060

KT

BEACHWAY

Petition

Mayor and Council

Beachway is located one block from Peace arch Hospital from Maple to Lee St on North Bluff and 1570 & 1580 Maple St.

This area of North Bluff is an arterial route to the highway 99 interchange and on a major bus route. It also allows the city to achieve higher density without blocking the cherished views of the mature neighborhoods to the South.

Consisting of:

- One six story below market rental building owned and operated by a non-profit on North Bluff containing 25 units.
- One six story market condo building on North Bluff containing 49 units.
- Fourteen three story Town Houses on Maple St.

As a member of the White Rock Community I would like you to know that I am in full support of this project.

	Name	Address	Phone
165	Gordon Ritz	Marine Dr	604-674-1217
166	Eileen Wiseman	1287 Johnston Rd	604-559-8362
167	W. Ritz	WHITE ROCK	604-800-7021
168	W. Ritz	WHITE ROCK	
169	Anthony L. Sept	White Rock	604-897-0124
170	Andrew McDonald	Wh. Rock	604-230-1895
171	Lance Cameron	W. Rock	604-838-1615
172	Jane Templeton	Winter St White Rock	
173	Doug Westcott	241 White Rock	403-331-5106
174	Kyle Matheson	White Rock	604-308-5357
175	P. Sihota	White Rock	6-782-4776
176	J. VAN STAVEREN	PARKER ST, WHITE ROCK, B.C	604-560-3613
177	E.L. Soper	#1 15156 Victoria Ave	604-531-1814
178	R. STEWART	15393 MARINE DR.	604-570-8076
179	D. Wain	W. Rock	604-617-3410
180	Jeanne May	White Rock	
181	G. Whitmarsh	14772 Upper Roper Dr	604-470-1786
182	J. Wain	1341 Marine St	604-774-1728

BEACHWAY

Petition

Mayor and Council

Beachway is located one block from Peace arch Hospital from Maple to Lee St on North Bluff and 1570 & 1580 Maple St.

This area of North Bluff is an arterial route to the highway 99 interchange and on a major bus route. It also allows the city to achieve higher density without blocking the cherished views of the mature neighborhoods to the South.

Consisting of:

- One six story below market rental building owned and operated by a non-profit on North Bluff containing 25 units.
- One six story market condo building on North Bluff containing 49 units.
- Fourteen three story Town Houses on Maple St.

As a member of the White Rock Community I would like you to know that I am in full support of this project.

	Name	Address	Phone
183	ASH Kaban	1243 BFs 7 Street	604 327 7773
X 184	Felicia Mena	1938 1578 St	778-384-9481
184	hader C	604 778 954 - 9877	
X 185	CHRISM	1358 ROYAL AVE	604 365 3064
186	Adam Hamby	15085 MARINE DR	604-812-5787
187	S BITZER	15280 Royal ave	604-619-4449
188	Peter Mura	15392 COLUMBIA ave	780 499 0700
X 189	Tracy Mikitt		778 953 4248
189	WYLOCK, E	15154 Kover Ave	778 336-4417
190	S. Renaud	1831 LIZAC DR.	
191	Chris Boff	209-1081 Market St.	604 785-0860
192	Jessie	Bay View 101	555-7755
193	Rebecca Sprue	15210 Pacific Ave	604 440-7465
X 194	Will	2576 W 10th	604 264-0449
194	Will	15417 COORS AVE	778 874-8683
195	S. Renaud	15127 MARINE DR	778-232-5787
196	A. Macdonald	15341 Pacific Ave	

BEACHWAY

Petition

Mayor and Council

Beachway is located one block from Peace arch Hospital from Maple to Lee St on North Bluff and 1570 & 1580 Maple St.

This area of North Bluff is an arterial route to the highway 99 interchange and on a major bus route. It also allows the city to achieve higher density without blocking the cherished views of the mature neighborhoods to the South.

Consisting of:

- One six story below market rental building owned and operated by a non-profit on North Bluff containing 25 units.
- One six story market condo building on North Bluff containing 49 units.
- Fourteen three story Town Houses on Maple St.

As a member of the White Rock Community I would like you to know that I am in full support of this project.

	Name	Address	Phone
197	MIKE HORNAR	1580 LANCASTER ST.	604 614 7526
198	Shawna Hornak	1590 Lancaster Street White Rock	604-218-1008
199	Mike Pearce	#307 1119 Vidal St W.R.	
200	Debra Pearce	#307 1119 Vidal St W.R.	
201	Tracy Pauluk	15674 NORTHBLUFF Rd W.R.	604-783-1563
202	Kate Skinner	1464 Maple St. White Rock.	604-7290630
203	Nath Wilke		
204	Aman Chera	1440 maple Street, White Rock	778-246-2895
205	Mandeep Chera	1440 maple Street, White Rock	604-584-2895
206	Conal Jussal	15688 66th AVE White Rock	604-897-8837
207	Joshaubhatredile	4-1426 Finlay St. W.R.	604-531-4454
208	Angela Moya	5-1426 Finlay St White Rock	
209	Elis Lb	3-1426 Finlay St White Rock	778-798-5319
210	Elis Lb	1495 Maple St White Rock	604-835-8007
211	Michelle Jackson	14862 Roper Ave W.R.	604-649-4645
212	Josh Jackson	14862 Roper Ave W.R.	604-807-7112
213	John Korponisky	149134 Thrift Ave W.R.	604-807-7112
214			604-230-4050

- As a member of the White Rock Community I would like you to know that I am in full support of this project.

3

Petition

100% Sent

Petition

Petition

[illegible]

Petition

[illegible]

Petition

[illegible]

Petition

[illegible]

Petition

[illegible]

BEACHWAY

Petition

Mayor and Council

Beachway is located one block from Peace arch Hospital from Maple to Lee St on North Bluff and 1570 & 1580 Maple St.

This area of North Bluff is an arterial route to the highway 99 interchange and on a major bus route. It also allows the city to achieve higher density without blocking the cherished views of the mature neighborhoods to the South.

Consisting of:

- One six story below market rental building owned and operated by a non-profit on North Bluff containing 25 units.
- One six story market condo building on North Bluff containing 49 units.
- Fourteen three story Town Houses on Maple St.

As a member of the White Rock Community I would like you to know that I am in full support of this project.

Name	Address	Phone
245 Edgar Quinn	13940 Coldcutt Ave White Rock B.C. V4B3B2	604-531-2531
246 Theresa Karponish	#104 14934 Thrift Ave W.R.	604-230-4050
247 Anne Quinn	13940 Coldcutt Ave, White Rock V4B3B2	604-531-2531
248 Mike Kitchen	15440 Russell Ave W.R.	604-240-0177
249 Lily Kitchen	15440 Russell Ave W.R.	604-240-0177
250 Stewart Peddemors	#305 1360 Martin St W.R.	604-329-6759
251 Lily Peddemors	#305 1360 Martin St W.R.	604-329-6759
252 Catherine Milby	15962 North Bluff Rd W.R.	604-536-7592
253 Andrew Milby	15962 North Bluff Rd W.R.	604-536-7592
254 Helen Ho	1071 Kent St W.R.	778-689-4418
255 Ken Johnson	#202 15097 Marine Dr W.R.	604-240-6660
256 Debbis Johnson	#202 15097 Marine Dr W.R.	604-240-6660
257 Davis Johnson	1308 Stevens St W.R.	604-614-9515
258 Elia Delorme	1308 Stevens St W.R.	604-789-1407
259 Dave Sharpe	#201 15097 Marine Dr W.R.	604-240-6660
260 Gordy Sangha	14181 Whately Ave W.R.	604-763-6450
261 Linda Sangha	14181 Whately Ave W.R.	604-763-6450
262 AL Hipsley	#1502 1473 Johnston W.R.	604-240-0855

Petition

[illegible]