

Tree Assessments performed for:
Mr. Don Longstaff
1062 Finlay St., White Rock
V4B 4K6
C/O 15600 Block Semiahmoo Ave, White Rock

Prepared by: *Outlook Arborist Services*

John Monk

ISA Arborist PN0401

Qualified Tree Risk Assessor

ITA Practical Horticulturalist

ITA Red Seal Utility Arborist

jmonktrees@gmail.com

604-816-2592

March 30th, 2021

Introduction:

Mr. Longstaff has contacted me, John Monk on referral from his tree company representative.

The purpose of my involvement with Mr. Longstaff is to discuss some trees beginning to block views for more than two properties.

We met on site and with other concerned neighbors, looked over what can be done to deal with maintaining a view with the least disturbance.

Views kept established in White Rock are clearly important and have been maintained for many years by residents able to prune trees.

Most hillside homes here have views and value the aesthetic benefits that make White Rock an attractive residential area.

These trees are on the corner of Semiahmoo and Findlay Street within municipal boulevard visible in this screenshot from the White Rock Mapping program.



Trees in this location primarily above 15605 & 15615 Moffat lane.

Because this is not private property and naturalized boulevard on a steep slope, this has become taken over by Himalayan Blackberries and now growing native Black Cottonwoods and possibly, Red Alders.

The Blackberries are invasive and difficult to control. However, they serve a purpose to prevent slope erosion and provide for birds for food and habitat. Within this area are these small Cottonwoods probably under ten years of age. They grow tall very rapidly and are just now beginning to block the view for numerous properties to the north.

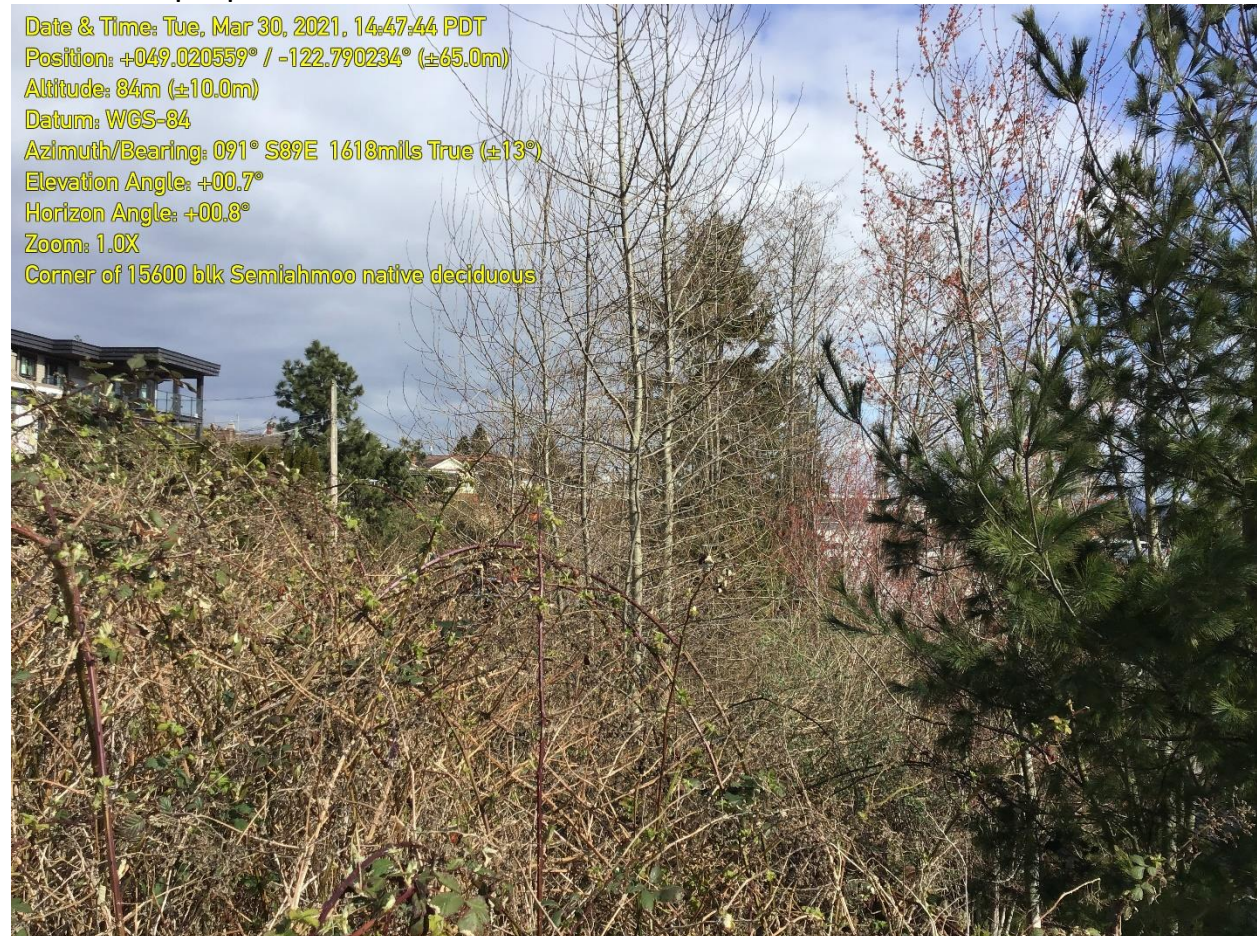

Trees on the slope now getting taller.

The property owners above this naturalized area wish to remove the trees at their expense and keep the blackberries. The homes below this slope also benefit from the slope erosion control. Blackberries are invasive but serve the erosion problem and some security by preventing access. Some privacy is also provided into the back yards of the Moffat properties.

Summary;

At this time, Mr. Longstaff on behalf of his neighbors wish to get Engineering approval to remove these trees to maintain the view they have always enjoyed. The contractor they wish to use needs to have insurance, Worksafe coverage and a business licence for White Rock.

Sincerely,

A handwritten signature in black ink, appearing to read 'John Monk', with a stylized flourish at the end.

John Monk
ISA Arborist PN0401
Tree Risk Assessor # 10685
ITA Practical Horticulturalist
ITA Utility Arborist