

**INTERIM PLAN**  
SCALE: 1:250

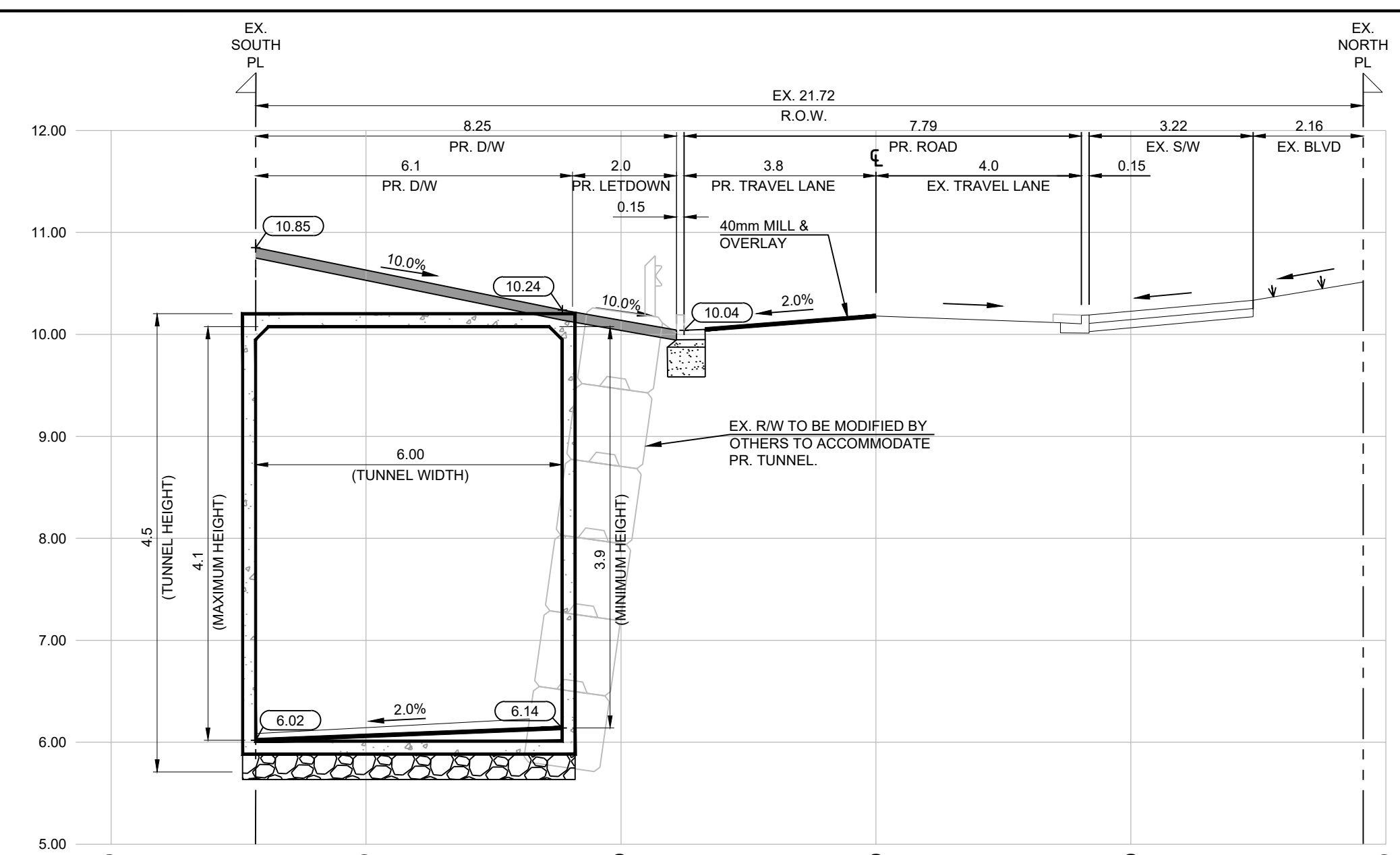

**SECTION C-C**  
SCALE: HOR. 1:100  
VERT. 1:50

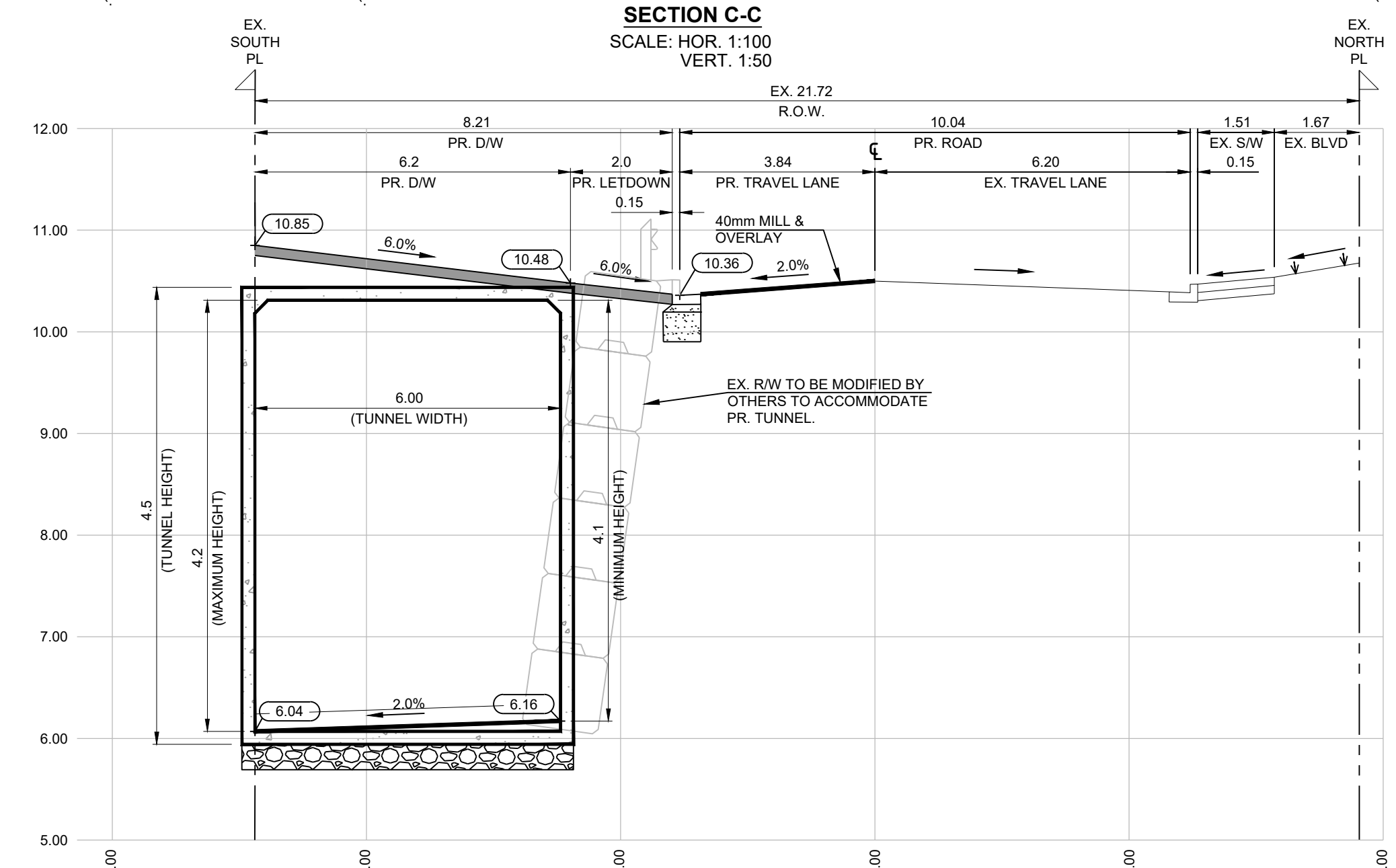

**SECTION B-B**  
SCALE: HOR. 1:100  
VERT. 1:50

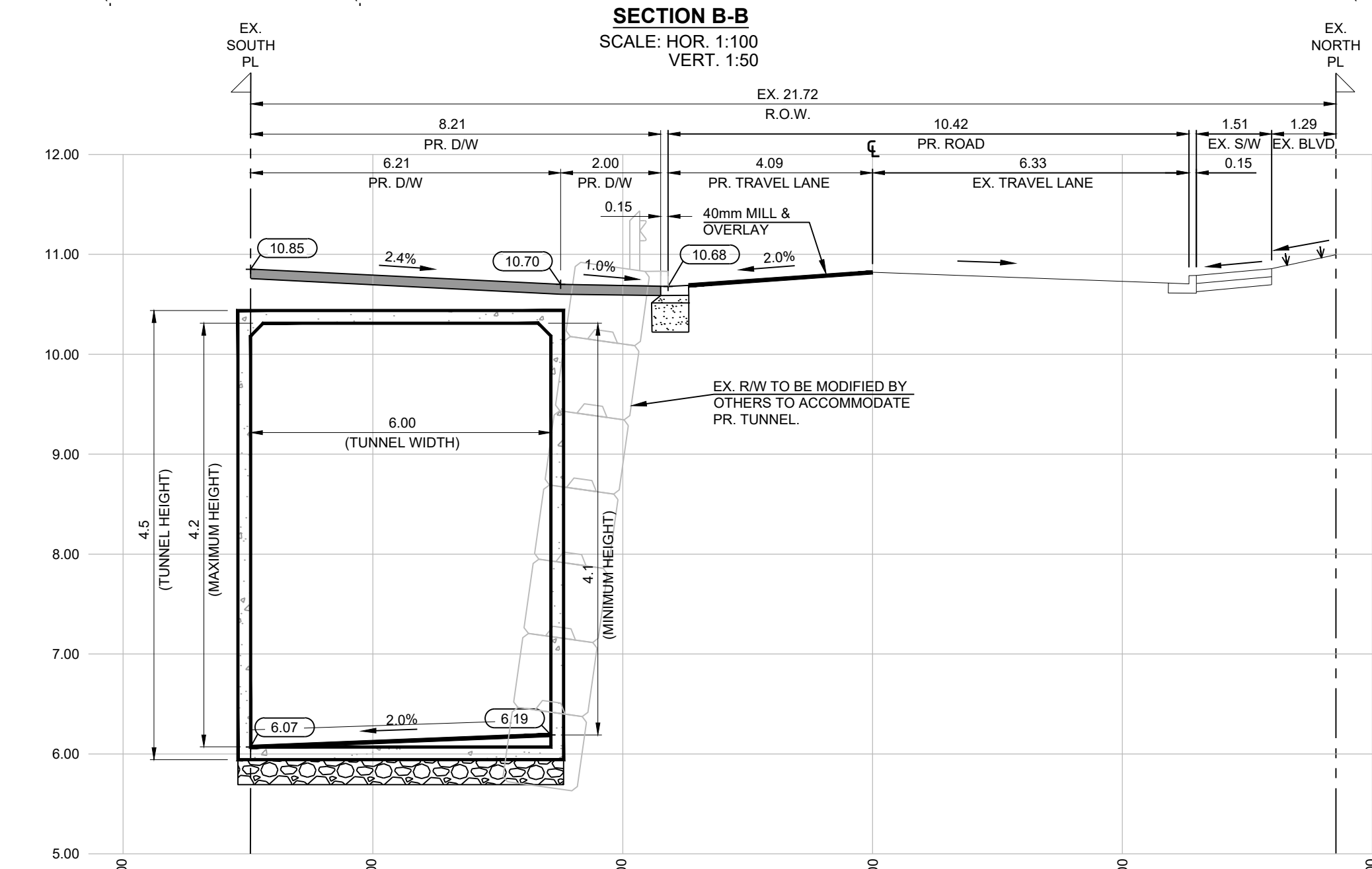

**SECTION A-A**  
SCALE: HOR. 1:100  
VERT. 1:50

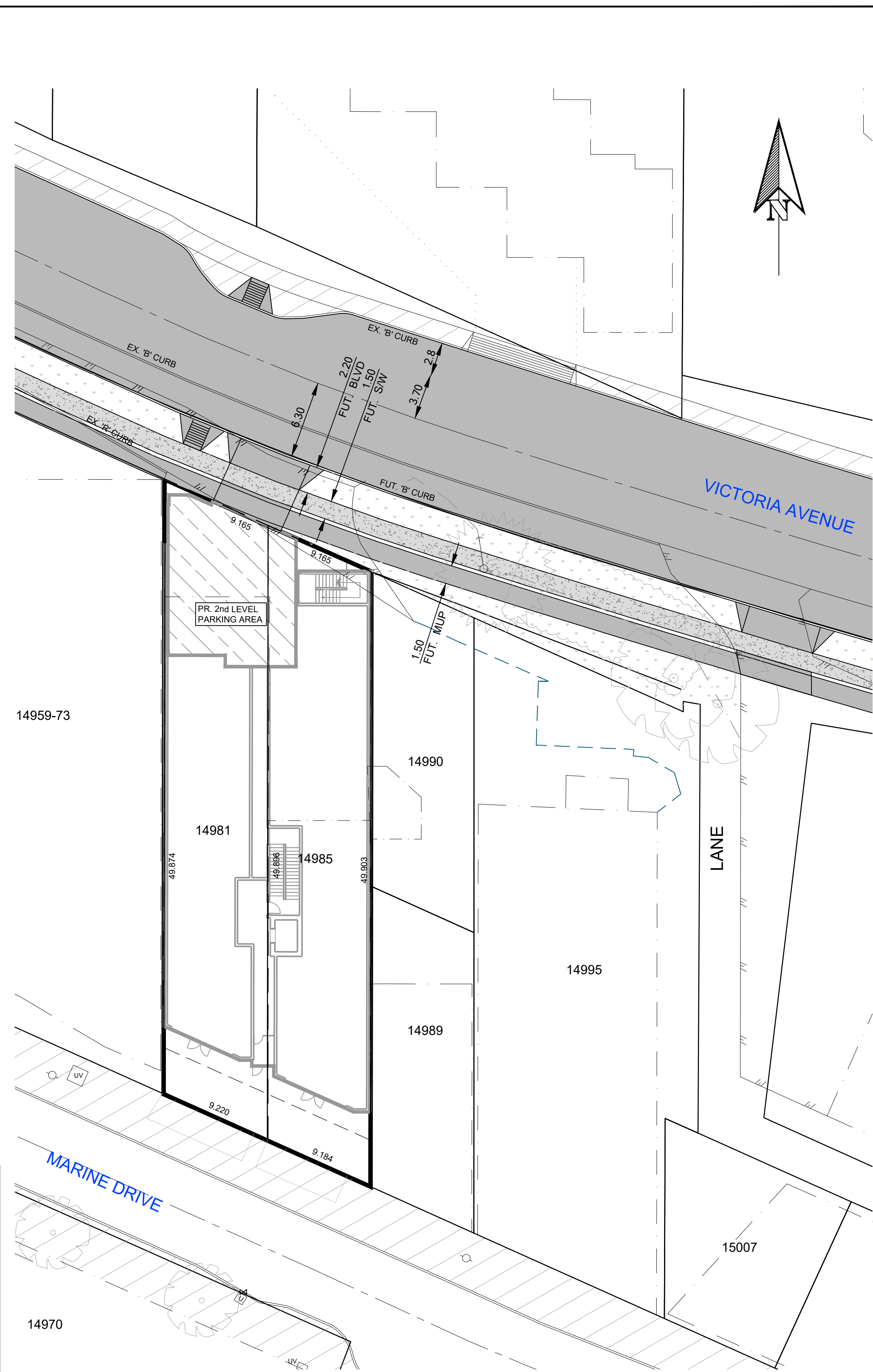

**ULTIMATE PLAN**  
SCALE: 1:250

ALL EXISTING UTILITIES, WHETHER SHOWN OR NOT ARE TO BE ADJUSTED TO SUIT THE NEW CONSTRUCTION.

LEGAL:  
LOT 2 (W 1/2) & LOT 3, SECTION 10, TOWNSHIP 1,  
NEW WESTMINSTER DISTRICT PLAN 2921

BENCHMARK:  
ELEVATIONS SHOWN ARE BASED ON MONUMENT #88H3883  
INTERSECTION OF MARINE DR. & VIDAL ST.  
ELEVATION= 3.303m

CLIENT  
**JACK WANG**

EMAIL: wang9925@gmail.com  
PHONE: 778.889.5458

**TERRA NOBIS**  
CONSULTING INC.

UNIT #203 - 15585 24TH AVENUE, SURREY, V4A 2J4  
PHONE: 604-946-3007  
EMAIL: INFO@TERRANOBIS.COM

REV.	DATE	DESCRIPTION	BY	APP'D
3.	05 SEP 2024	FOR DP SUBMISSION	JL	AJ
2.	15 AUG 2024	FOR DISCUSSION	JL	AJ
1.	02 JUN 2024	FOR DISCUSSION	JL	AJ
0.	18 JUN 2024	FOR DISCUSSION	JL	AJ

PERMIT TO PRACTICE  
NUMBER: 1000490

BY: JL

SEAL

05 SEP 2024

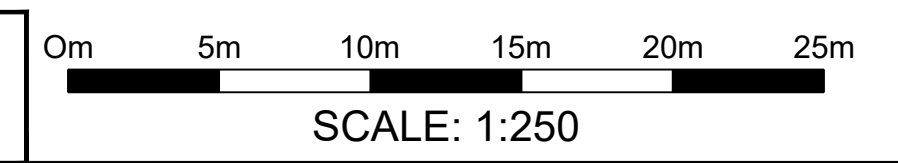

TITLE  
**INTERIM/ULTIMATE DRIVEWAY LAYOUT**

DESCRIPTION  
**SEASIDE RESIDENCE**  
**14981 & 14985 MARINE DRIVE, WHITE ROCK**

PROJECT NUMBER 24026	DRAWING NUMBER <b>1</b>
SCALE: AS SHOWN	DATE: JUN 2024
DRAWN: DVH	APPROVED: AJ
DESIGNED: JL	DESTROY ALL PRINTS BEARING PREVIOUS NUMBER:
REVISION: 3.	OF 1