

THE CORPORATION OF THE  
**CITY OF WHITE ROCK**  
CORPORATE REPORT



**DATE:** June 24, 2024

**TO:** Mayor and Council

**FROM:** Justin Schneider, Manager, Parks

**SUBJECT:** Generations Playground Splash Pad – Early Concept Review and Recommendations

---

**RECOMMENDATIONS**

THAT Council:

1. Review the pros/cons of the three (3) concept design options; and
  2. Direct Staff to proceed with Concept Design #1 as per the reasons outlined in the report
- 

**EXECUTIVE SUMMARY**

This corporate report provides Council with the opportunity to review three (3) layout options for the new Generations Playground Splash Pad in Centennial Park, and to provide recommendations.

**INTRODUCTION/BACKGROUND**

The Generations Playground Splash Pad is intended to provide a refreshing and interactive water play space for residents and visitors of all ages and abilities. Three (3) initial concept designs are outlined in **Appendix A**. Each design offers unique advantages and potential limitations, which are outlined within this report.

Proposed features include interactive water play elements, designated picnic areas, and options for relocating and revising existing fitness equipment on site. Situated within Centennial Park, Generations Playground offers an inclusive play environment for children of all abilities. The splash pad will seamlessly integrate with the park's natural beauty, enhancing the recreational offerings while respecting the adjacent Ruth Johnson Park and ravine ecosystem.

All designs incorporate the following positive impacts:

- **Increased Play Opportunities:** Offers a fun, interactive water play space alongside traditional playground equipment and splash pad, catering to a wider range of interests and abilities.
- **Inclusion and Accessibility:** Creates a space where children of all abilities can play together, fostering social interaction and a sense of community.
- **Enhanced Cooling and Fun:** Provides a refreshing refuge during hot summer months, extending playtime and encouraging outdoor activity.
- **Multi-generational Appeal:** Caters to families with children of different ages and abilities, offering activities for both parents and children to enjoy together.

- **Improved Park Utilization:** Increases foot traffic and overall park usage, revitalizing the space and promoting community engagement.

### **Peace Arch Hospital Foundation (PAHF) Contribution**

The PAHF has generously committed up to \$100K towards the splash pad project. A significant portion of this contribution will be used to relocate and repurpose the existing outdoor fitness equipment. The existing fitness area will be upgraded and relocated to an adjacent location that will maximize usage in a more effective way.

### **Recommended Option**

Design Option #1 is recommended as the strongest layout option for the following reasons:

- **Optimizes** sun and shade exposure with all programs;
- **Efficient** use of space that maximizes functionality within existing area;
- **Intuitive** flow promoting user-friendliness;
- **Strategic** placement of all program areas to minimize conflicts and maximize safety.

**Appendix B** illustrates visual examples of potential splash pad and water play elements that could be incorporated into the final design, subject to availability and price.

With construction tentatively scheduled to begin in fall 2024, subject to finalization, this project represents a significant step forward in enriching the recreational landscape of Centennial Park.

### **FINANCIAL IMPLICATIONS**

Funds for the project are included in the approved 2024 Financial Plan.

### **INTERDEPARTMENTAL INVOLVEMENT/IMPLICATIONS**

Recreation and Culture and Engineering and Municipal Operations staff are working together on this project, especially with respect to the fitness equipment priority.

Sustainability is a key priority for this project. In addition to optimizing water use and maximizing play value with on-demand activators, we are committed to incorporating a water management system that minimizes environmental impact. During the next design phase, we will explore options for a flow-through system that diverts a portion of water away from the sanitary sewer and towards a percolation or repurposing system.

This approach aligns with our commitment to environmental responsibility and helps ensure the long-term sustainability of the Generations Playground Splash Pad.

### **ALIGNMENT WITH STRATEGIC PRIORITIES**

The Generations Playground Splash Pad is a Council proposed and endorsed project, and is in alignment with Community and Infrastructure priority areas of focus. The Community priority identifies that we foster a livable city with connected residents enjoying distinctive places and activities, and the Infrastructure priority identifies that we plan, build, and maintain infrastructure to enhance quality of life and civic service delivery while mitigating and adapting to environmental impacts.

**OPTIONS / RISKS / ALTERNATIVES**

The 3 proposed layout options are available for Council’s consideration.  
Staff recommend Design Option #1.

**CONCLUSION**

In conclusion, this report has presented three initial concept designs for the Generations Playground Splash Pad in Centennial Park. Each design offers unique advantages and considerations. Based on evaluation of the strengths and potential impact captured in the overview of the three concept designs, staff recommends **Concept Design #1** as the most viable option due to its efficient use of space, optimal sun exposure for both play and relaxation, and seamless integration with the surrounding environment.

Following Council's review and direction, the chosen design will be further developed with community engagement and finalized during the following design stages. This exciting project aligns with Council's priorities and promises to be a valuable addition to Centennial Park, providing a refreshing and inclusive play space for residents and visitors of all ages.

Respectfully submitted,

Approved by,



Justin Schneider, Landscape Horticulturist  
Manager, Parks

Jim Gordon, P.Eng.  
Director, Engineering & Municipal Operations

**Comments from the Chief Administrative Officer**

I concur with the recommendation(s) of this corporate report.

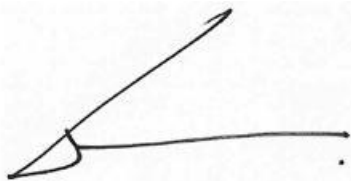

Guillermo Ferrero  
Chief Administrative Officer

Appendix A: Concept Design Options  
Appendix B: Visual Reference Guide

## Appendix A: Concept Design Options

### Design Option #1 [recommended]

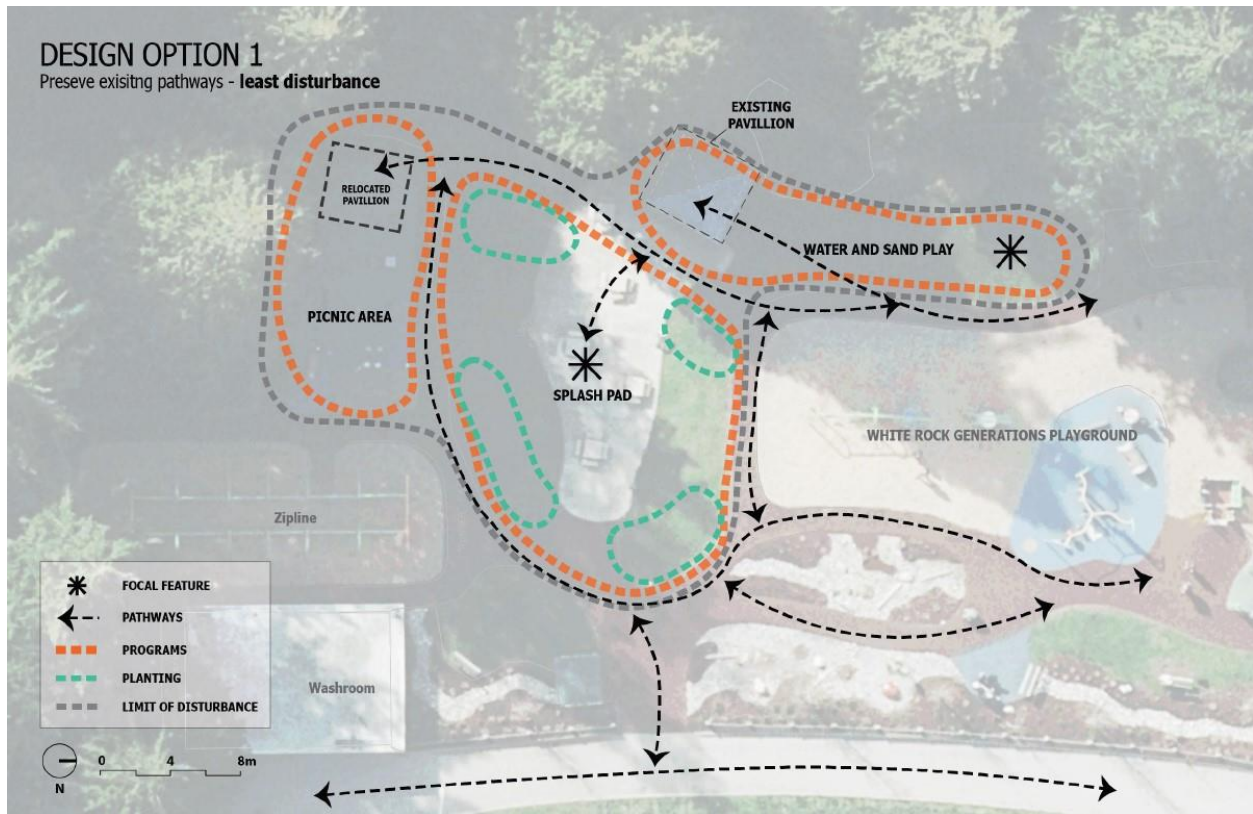

#### Pros:

- **Sun and Shade Optimization:** Provides a balance of sun exposure for water play and shaded areas for relaxation or supervision;
- **Efficient Use of Space:** Minimizes disruption to existing features and utilizes space strategically, maximizing functionality within the existing layout;
- **Intuitive Flow:** Creates a clear and natural flow between play spaces, promoting safe navigation and user-friendliness;
- **Strategic Placement:** Well-positioned splash pad and water play features minimize potential conflicts and ensure safety for picnicking families.

#### Cons:

- Does not maximize size of splash pad; *Note: this feedback has been communicated to the designer and can be integrated into design without conflict.*

## Design Option #2

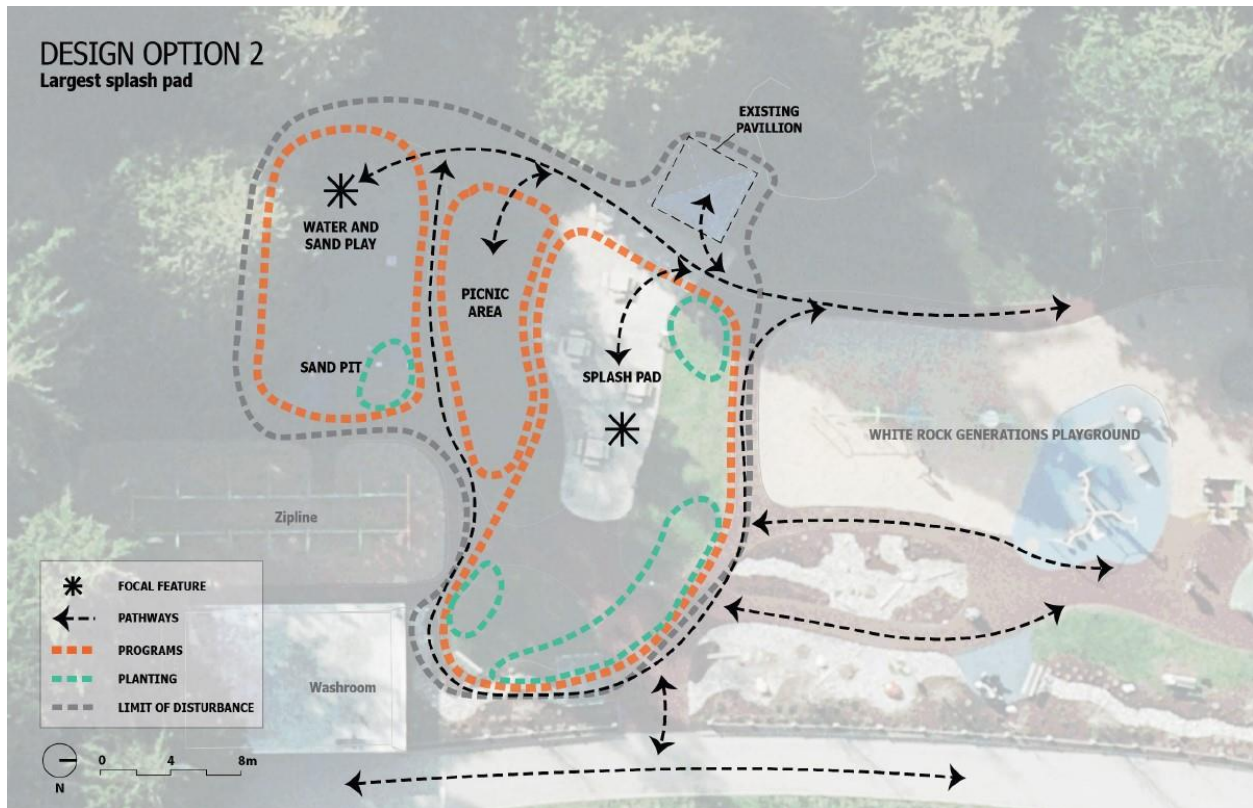

### Pros:

- Maximizes splash pad size; *see previous note.*

### Cons:

- Does not optimize existing sun and shade exposure;
- Inefficient use of space.

### Design Option #3

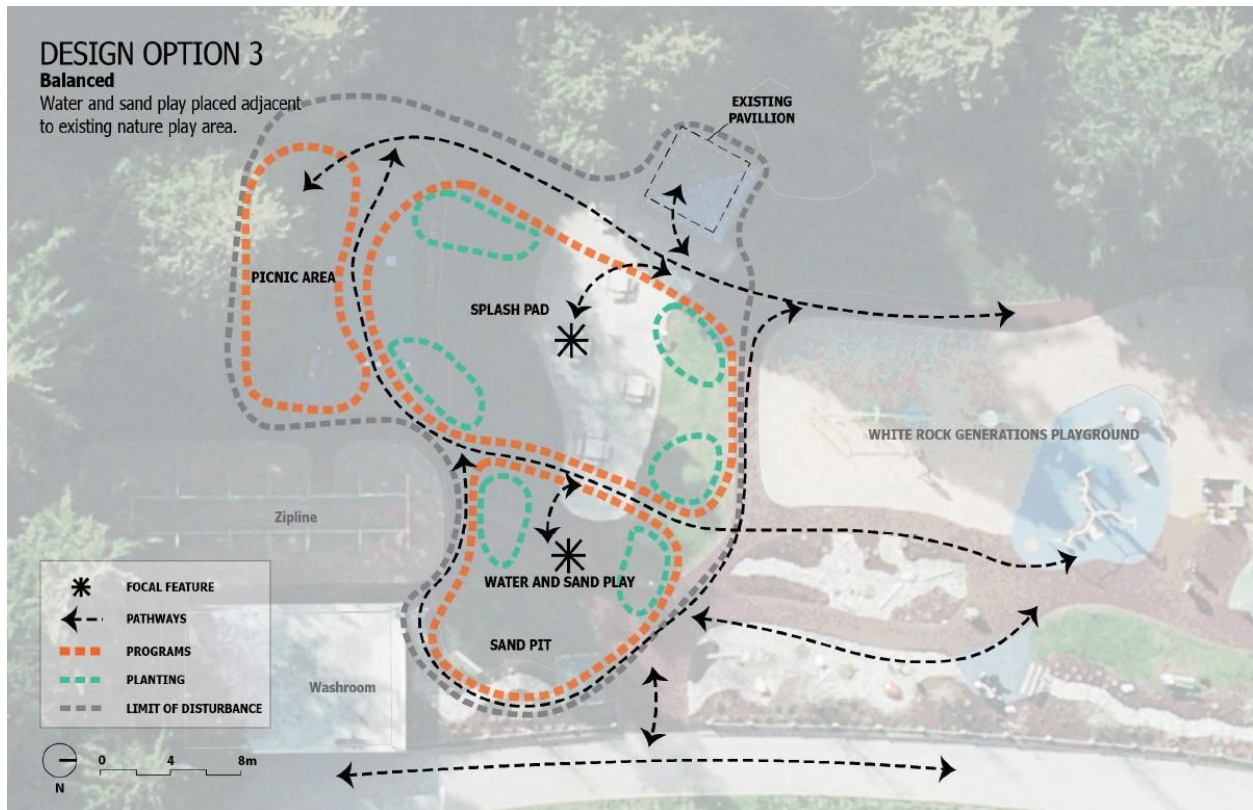

Pros:

- Positions water play space adjacent to existing nature play elements;

Cons:

- Unintuitive flow that increases potential safety hazards between programs;
- Water play placement increases potential for cross-contamination.

**Appendix B: VISUAL REFERENCE GUIDE**

For your reference, we've included examples of **splash pad** and interactive **water play** space elements that could be incorporated into the final design. These options prioritize aesthetics that complement the adjacent natural park ecosystem and the seaside character of our city (subject to availability and price).

**I. Splash Pad Space**



II. Water Play Space

